



ANTIOCH

Antioch General Trading L.L.C.

Al Khabisi, Deira, Dubai Plot No 128-422,
Ahmed Redha Al Ansari Building, Office 203.
P.O.Box 114020, Dubai, United Arab Emirates

Mob & Whatsapp: +971 50 652 4074

Email: info@antiochdubai.ae

mohammed@antiochdubai.ae



Product Technical Atlas



we love our lights, we enjoy our life



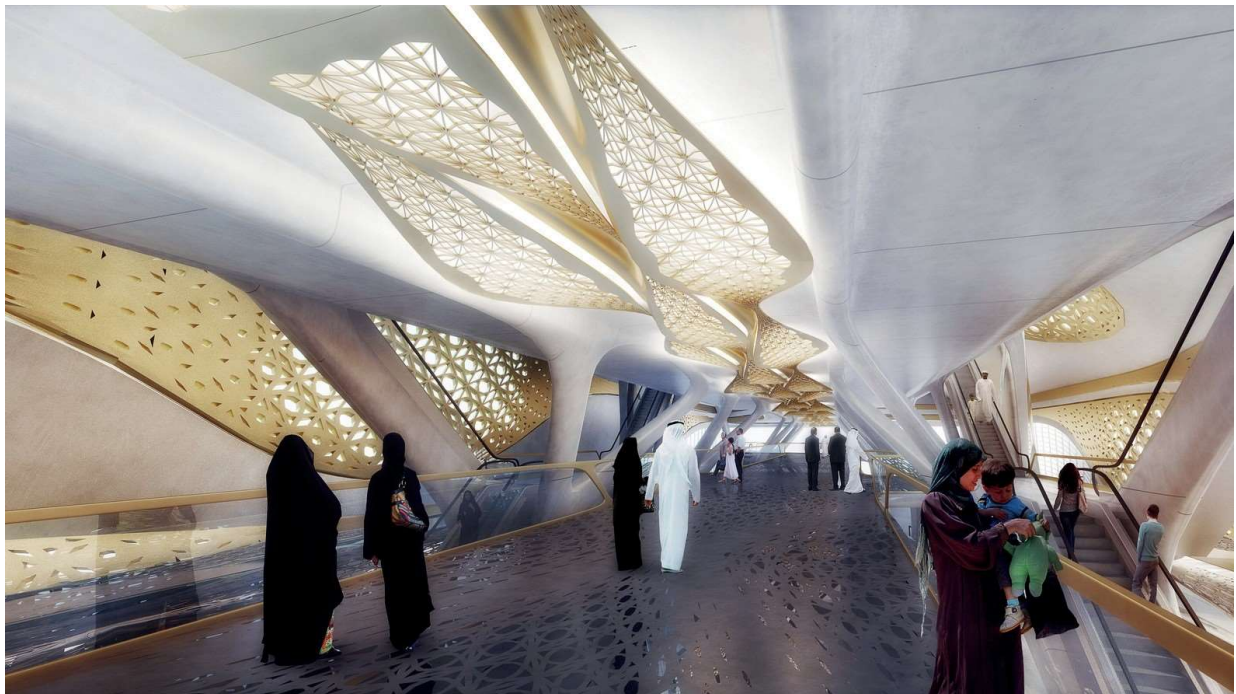
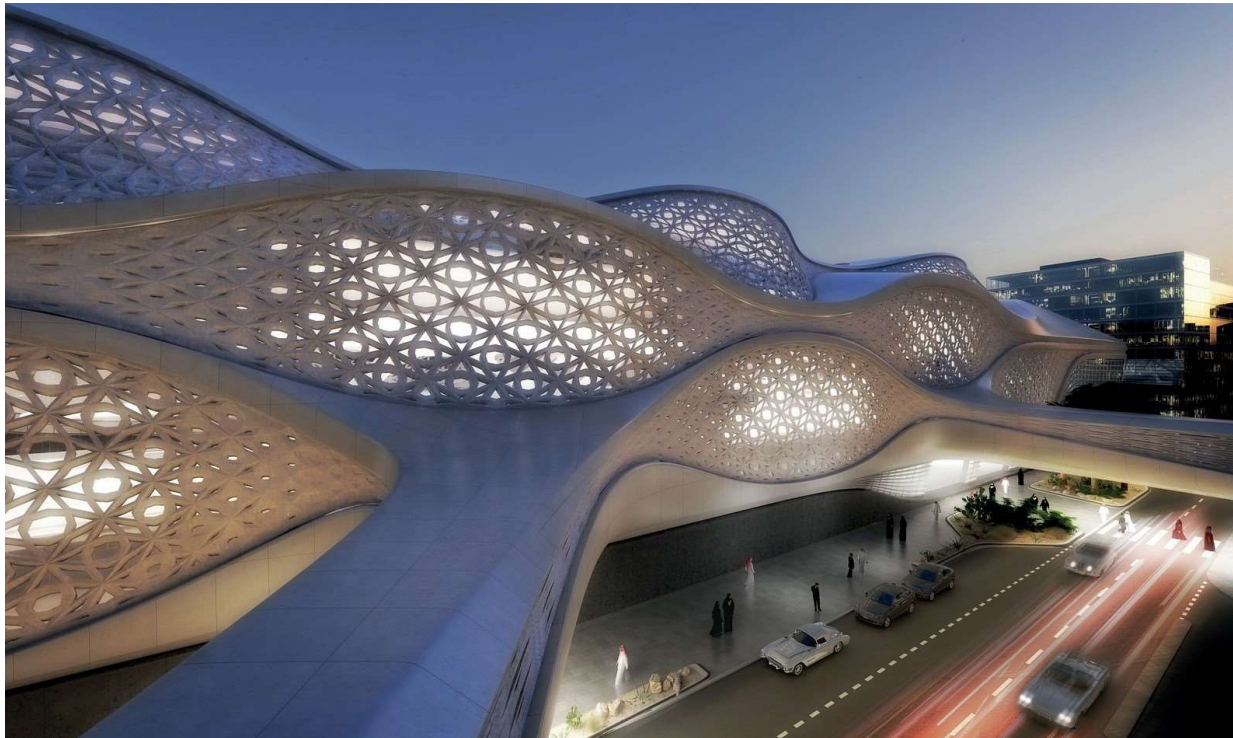



万凶吃沙 } 三 心
 dl 、孔沉Uzid Jafonl Jharzin町

PERSPECTIVE VIEW





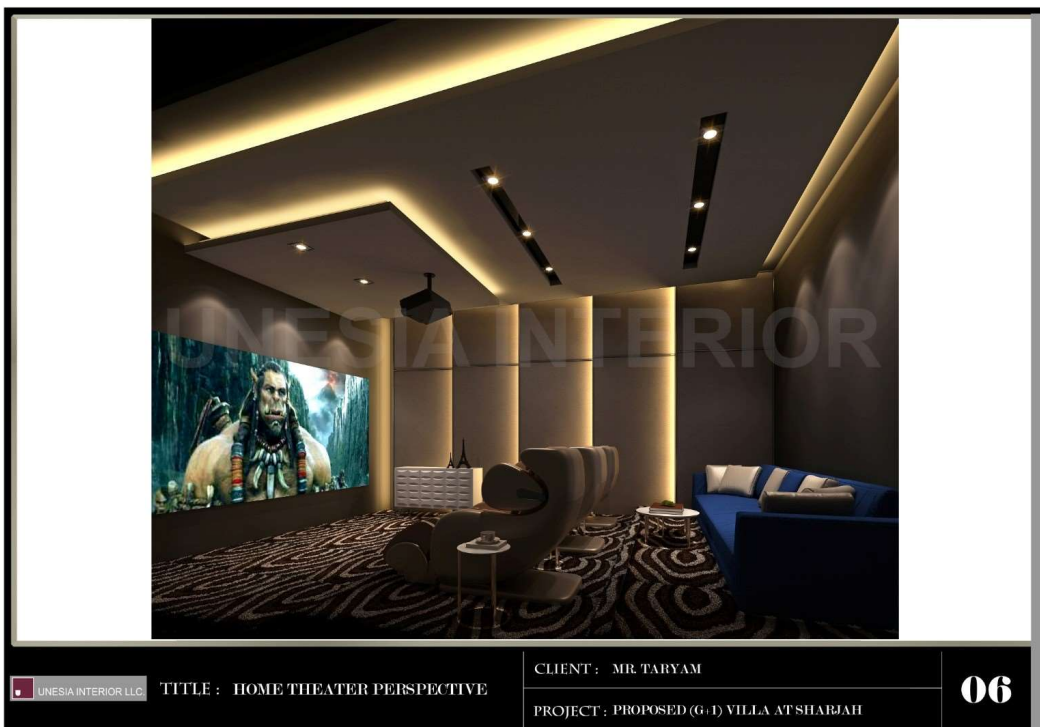







اكسبو الذيد Expo Al Dhaid





EXTRUSION BENEFITS

- Moderate to high surface area
- Machinable
- Available in any length
- Hundreds of standard profiles

DIE-CASTING BENEFITS

- Complex shapes
- Single manufacturing step
- Durable & rigid
- Minimal secondary processes
- Detailed surface
- High yield rate

ALUMINIUM DIE-CASTING

Die casting is the manufacturing process of injecting liquid molten metal under high pressure into a high precision mold. It is often used to mass produce complex three-dimensional structures with a detailed surface texture. This is done within a single manufacturing step without post treatment. The surface of the die is quickly cooled by the mold and the slowly cooling core creates a negative pressure within the cast metal, which in turn makes it more rigid and increases its structural integrity.



THE LANGUAGE OF LIGHTING

WATTAGE

THE LIGHT'S ENERGY CONSUMPTION



Lower wattage LED use less electricity

CRI

THE ABILITY OF REVEAL COLORS OF OBJECTS



A higher number more true colors to reveal

LUMENS

MEASURE THE LIGHT'S BRIGHTNESS



A higher number means more output of light

CCT

A SCALE FOR COLOR OF LIGHT



A higher number means a cooler light.

BEAM ANGLE

A SCALE FOR ANGLE OF LIGHT

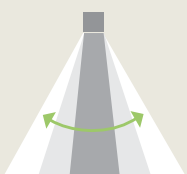

Narrow for spotlight
wide for flood lights

UGR

A SCALE OF COMFORTABLE OF LIGHTING



Below 16 is good
more than 25 is bad

GENERAL COLOUR RENDERING INDEX (RA) AND SPECIAL CRI (RI)

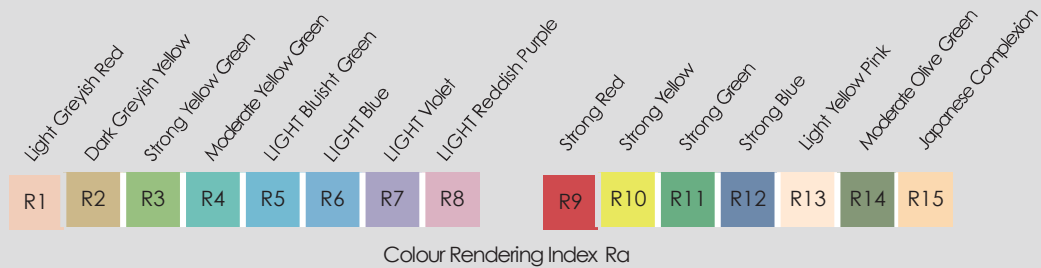

The general Colour Rendering Index looks at the first 8 colour indices (R_i). Ra is the average of the eight R_i values and is stated as CRI with a maximum value of 100. Special CRI refers to the remaining 6 colours (9 to 15) including the saturated colours and skin tones. Therefore manufacturers often aim for interior lighting LEDs to have strong R₉ and R₁₃/R₁₅ values, as this improves the appearance of complexion giving the skin a healthy looking glow.

Ra

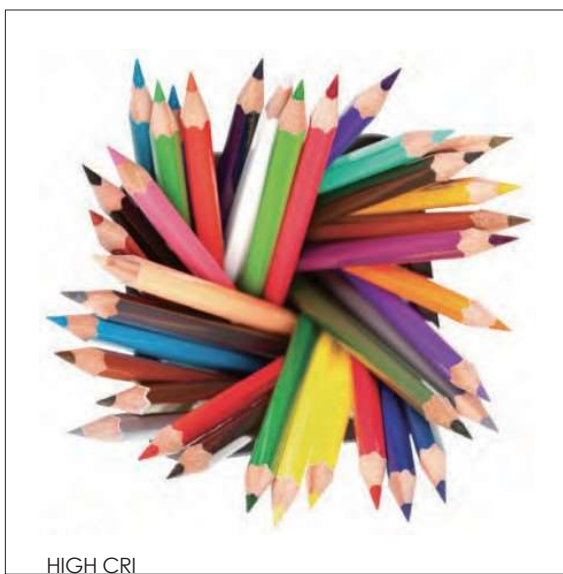
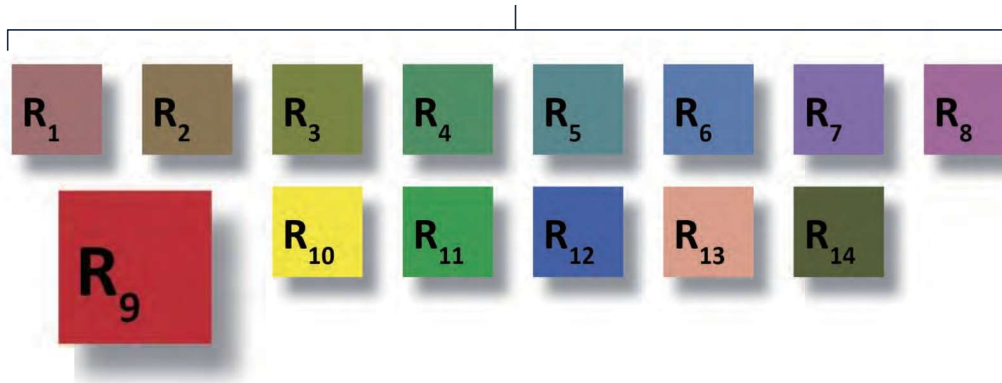

CORRELATED COLOR TEMPERATURE

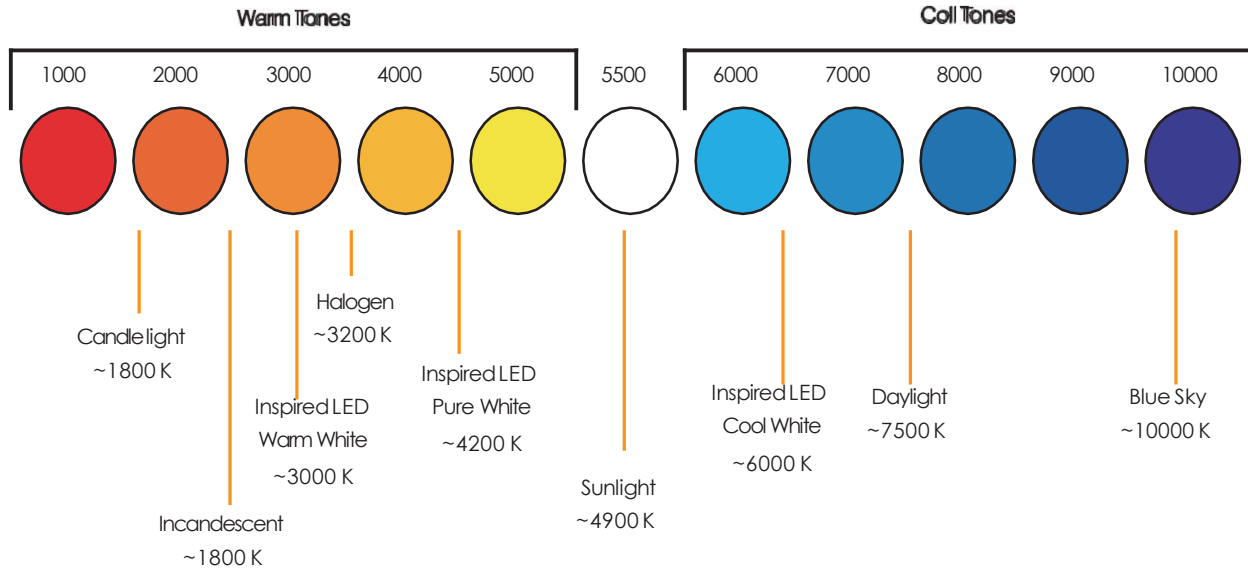

The color temperature of a light source is the temperature of an ideal black-body radiator that radiates light of comparable hue to that of the light source. Color temperature is a characteristic of visible light that has important applications in lighting, photography, videography, publishing, manufacturing, astrophysics, horticulture, and other fields. In practice, color temperature is only meaningful for light sources that do in fact correspond somewhat closely to the radiation of some black body, i.e., those on a line from reddish/orange via yellow and more or less white to blueish white wavelengths (resulting in a more blueish white) for higher temperatures.; it does not make sense to speak of the color temperature of, e.g., a green or a purple light. Color temperature is conventionally expressed in Kelvin, using the symbol K, a unit of measure for temperature based on the Kelvin scale.

Color temperatures over 5,000K are called cool colors (bluish white), while lower color temperatures (2,700–3,000 K) are called warm colors (yellowish white through red).[1] This relation, however, is a psychological one in contrast to the physical relation implied by Wien's displacement law, according to which the spectral peak is shifted towards shorter

POWER DRIVER & CONTROL SYSTEM



COMPLIANT WITH HEALTH NORMS

TRIDONIC RIPPLE FREE LED DRIVERS (<3%) ENSURE THE LOWEST LEVEL OF LIGHT FLICKERING. IN LOW AND HIGHER OUTPUT LEVELS, THE FLICKERING IS REDUCED TO A LEVEL, IMPERCEPTIBLE FOR THE HUMAN EYE. HOWEVER, SURVEYS HAVE PROVEN A RELATION BETWEEN FLICKERING AND HEALTH PROBLEMS. THEREFORE, THE APPLICATION OF LIGHTING SYSTEMS WITH A LOWER FLICKER INDEX IS AN IMPORTANT FACTOR IN BOTH COMMERCIAL AND RESIDENTIAL AREAS.



VIDEO/PHOTO PROOF

LIGHTING WITH A LOW FLICKERING INDEX IS ESSENTIAL IN AREAS WHERE PHOTO AND VIDEO CAMERAS ARE USED. FLICKERING LIGHT SOURCES HAVE A NEGATIVE EFFECT ON THE QUALITY OF PHOTOS AND VIDEO FOOTAGE.

LONGER LIFETIME

IN ADDITION TO NEGATIVE EFFECTS FOR HUMAN HEALTH, HIGH RIPPLE CURRENT WILL HARM THE LED, THE LED DRIVER AND THE EFFICIENCY OF THE SYSTEM IN GENERAL.



SURGE PROTECTION

THE TRIDONIC DRIVERS ARE PROTECTED AGAINST SURGES UP TO 4KV. THIS IS WELL ABOVE THE NORM OF 1KV. MANY LED BULBS ARE PROTECTED UP TO 500V. THE SURGE PROTECTION LEVEL OF THE TCL DRIVERS RESULTS IN AN EXTREMELY LOW DEFECT RATE OF AROUND 0.1%.

HIGHER LIGHT OUTPUT

A LED DRIVER WITH A LOWER RIPPLE FACTOR IS 5% MORE EFFICIENT IN TERMS OF LIGHT OUTPUT.



RIPPLE FREE

TRIDONIC LED DRIVERS ARE PROVIDED WITH A SOPHISTICATED MULTISTAGE CIRCUIT TO SUPPLY THE LEDS WITH A PERFECT CURRENT (A LINE). LOW QUALITY DRIVERS WITH A POOR RIPPLE FACTOR MAY CAUSE PROBLEMS INCLUDING HEADACHE, EYE STRAIN, IMPAIRED VISUAL PERFORMANCE OR, IN EXTREME CASES, EPILEPTIC SEIZURE.

DALI DIM

DALI SYSTEM INTELLIGENT manage LED Driver Series

Output current accuracy: $\pm 5\%$
 Efficiency: $\geq 87\%$
 Ripple current: $\leq 5\%$
 Standby power consumption: $< 0.5W$
 Dimming range: 1-100%
 Dimming depth: 1-100%
 Support DALI Dim, Switch/PushDim, intelligent control
 Average lifetime: 50,000 h
 Warranty: 5 years
 Abnormal protection: OCP, SCP, OLP, OVP, OTP



TRIDONIC
 enlightening your ideas

3AAA

OSRAM
PHILIPS

SAFETY AND SECURITY

EXCESSIVE HEAT /SHORT CIRCUIT
 PROTECTION PROTECTION AGAINST VOLTAGE
 SPIKES IN THE ELECTRICITY NET OVERLOAD
 PROTECTION



CC TYPE

INDEPENDENT TYPE LED Driver Series

Output current accuracy: $\pm 5\%$
 Efficiency: $\geq 90\%$
 Ripple current: $< 10\%$
 Average lifetime: 50,000 h
 Warranty: 5 years
 Abnormal protection: OCP, SCP, OLP, OVP
 Certificates: ENEC, CE, CB, SAA, RCM, CCC, RoHS, REACH



FEATURES & BENEFITS

- SURGE PROTECTED UP TO 4KV
- VARIOUS DIMMING OPTIONS (1-10V, PUSH, DALI)
- MULTIPLE OUTPUT CURRENT OPTIONS THROUGH DIP SWITCH SETTINGS
- HEAT GENERATION AT FULL LOAD STAYS WELL BELOW THE ALLOWED MAX. 70° C
- (TC) UPCOMING VERSIONS WITH BLUETOOTH LOW ENERGY COMPATIBILITY
- ENEC/EMC COMPLIANT
- STRAIN RELIEF IN ACCORDANCE WITH EUROPEAN SAFETY STANDARDS
- ACTIVE POWER FACTOR (PF) CORRECTION
- HIGHEST QUALITY A- BRAND ELECTRONIC COMPONENTS

COUPLE



Model No.: PPG-HD001-CGXX

Model nO.: PPG-HD002-CGXX

D1,D2 20W

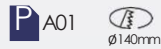

5 YEARS GUARANTEE

SURFACE FINISH: WHITE, GREY, BLACK

THERMALLY ENGINEERED HEATSINK IS ROBUST AND OFFERS COOLER OPERATION HIGH GRADE

DIFFUSER PROVIDES UNIFORM LIGHT AS WELL AS GREATLY ILLUMINATES ENVIRONMENT.

ANTI-GLARE REFLECTOR CREATES VISUAL COMFORT

EASY TO INSTALL WITH TWO SPRING CLIPS

EASY TO REPLACE MR16 OR GU10 HALOGEN SMALL SPOTLIGHTS.

NON-DIM IS STANDARD, DIM IS OPTIONAL.

RECESSED DOWNLIGHT



CE RoHS



Model No.: PPG-HD001-CGXX

D1, D2

Model No.: PPG-HD002-CGXX

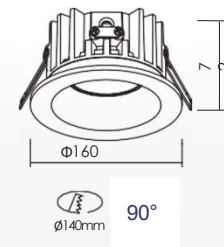

Trim Finish Optional:

- ☐ Matte White RAL 9016
- ☐ Matte Grey RAL 9006
- ☐ Matte Black RAL 9005



Standard Mechanical Parameters

MAIN BODY MATERIAL: ALUMINIUM DIE-CASTING
 SURFACE FINISH: MWRAL 9016
 IP: 44
 OVERALL DIMENSION: $\Phi 160 \times 72 \text{MM}$
 CUTOUT: $\Phi 140 \text{MM}$

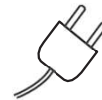

Standard Optical & Electrical Characteristics

LED BRAND: LUMILEDS
 DRIVER BRAND: 3AAA
 INPUT: 100-265V AC 50/60HZ
 CCT: 4000K
 Macadam3
 CRI: > 90
 PF>95
 SYSTEM OUTPUT: 3000LM
 SYSTEM POWER: 20W
 BEAM: 90°

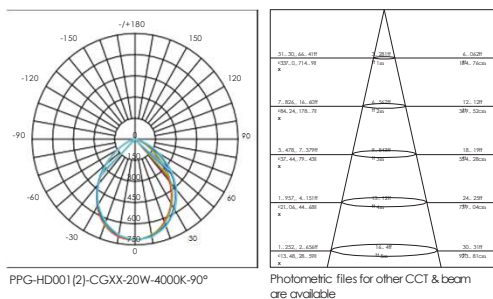

Standard Packing Information

CARTON BOX: 680X425X350MM
 PCS/CARTON: 32PCS
 CARTON G.W.: 21.0KG



Recessed ceiling-mounted downlight

Model No.: PPG-HD001-CGXX
PPG-HD002-CGXX

ON/OFF	IP44	LED 4000 K		CQS 80-85
--------	------	---------------	--	--------------



Product description

- LED downlight, 20 W, for recessed ceiling mounting with transparent (CLEAR) diffuser
- Beam angle 90°
- Integrated ballast , installation without further accessories
- White painted aluminum reflector, white color powder painted (RAL9003) die-cast aluminum trim, aluminum heat sink for heat dissipation.
- Color temperature 4000 K
- Excellent light quality, suitable for screen-based work places in accordance with EN 12464-1 and for technical drawing



Technical data

GENERAL

Device category	Downlight
Conformity	CE, RoHS, CB, TUV
Warranty	5 years

ATTACHMENT

Installation type	Recessed mounting
Installation position	Ceiling

HOUSING

Dimensions	Height/Depth 72 mm, Ø 160mm
Weight	450g
Material	powder-coated Die-cast aluminium
Protection type	IP20 /IP44 below the ceiling (built-in)
Permissible ambient temperature	-20 °C...+40 °C
Colour	white
Glow wire test in accordance with IEC 60695-2-10	850 °C

ELECTRICAL VERSION

Protection class	II
Nominal voltage	100 - 265 V / 50 - 60Hz

LIGHT

Diffuser	transparent
Light emission	direct
Beam angle	90°
Unified Glare Rating	≤ 16
Flicker factor	< 3 %
Rated output Power	20 W
Luminous flux	3000 lm
Luminous efficacy	150 lm/W
Colour temperature	4000K
Colour rendering index Ra	> 90
Colour tolerance	3 SDCM
Color Quality Scale	≥ 85
L70B10 lifetime at 25 °C	90000 h
Life time L70B50 at 25 °C	95000h
Life time L80B10 at 25 °C	55000h
Life time L80B50 at 25 °C	60000h
Life time L90B10 at 25 °C	25000h
Life time L90B50 at 25 °C	30000h

Installation Diagram *turn off the power supply before installing or unloading

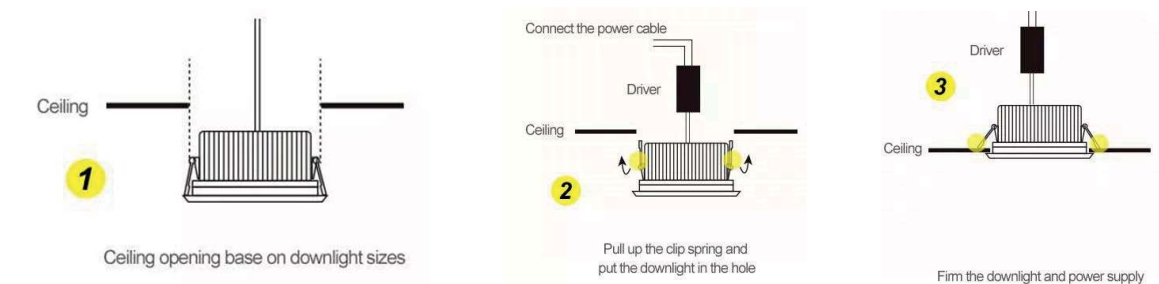

EMERGENCY RECESSED DOWNLIGHT



CE RoHS

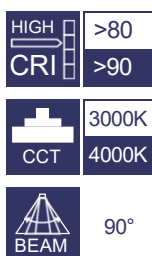

D1-EP

Model No.: PPG-HD001-EP-CGXX



EMERGENCY RECESSED DOWNLIGHT CAN ADD A MORE UNIQUE ASPECT TO YOUR PERSONAL SPACES. YOUR CHOICE OF LIGHTING HAS THE POWER TO CREATE TONES OF SOPHISTICATION AND ELEGANCE COOL PROFESSIONALISM, WARMTH OR TRENDY STYLE DEPENDING ON YOUR PERSONAL DESIGN VISION. WE SPECIALIZE IN SUPPLYING QUALITY PIECES THAT HIGHLIGHT ITS NATURAL DECOR AND CREATE ROOMS THAT ARE VISUALLY IMPRESSIVE AND MAKE YOUR CLIENTS FEEL RELAXED AND HAPPY.

Product description

- Self contained emergency lighting LED Driver for manual testing
- For LED modules with a forward voltage of 10–54 V
- SELV for output voltage <60 VDC
- Low profile casing (21 x 30 mm cross-section)
- For luminaire installation
- Nominal life-time up to 100,000 h
- 5-year guarantee

Standards

- EN 61347-1
- EN 61347-2-13
- EN 61347-2-7
- EN 55015
- EN 61000-3-2
- EN 61000-3-3
- EN 61547
- EN 60068-2-64
- EN 60068-2-29
- EN 60068-2-30
- EN 62384
- according to EN 50172
- according to EN 60598-2-22

Properties

- Non maintained operation
- 1or 3h rated duration
- Operating time selectable with plug (duration link)
- Compatible with all dimmable and non-dimmable constant current LED Driver (see chapter 5.4)
- 3-pole technology: 2-pole LED module changeover and delayed power switching for the LED Driver
- Automatic shutdown of output if LED load is out of range
- Constant power output
- Maximum light output for all LED modules
- Electronic charge system
- Deep discharge protection
- Short-circuit-proof battery connection
- Polarity reversal protection for battery provided by 3-pole connector
- Automatic detection of the connected battery technology (NiMH or LiFePO₄ batteries)

Expected life-time with LiFePO₄ batteries

EM converterLED BASIC 202	tc	65 °C	70 °C	75 °C
MH/LiFePO4 50V	life-time	> 100,000 h	>100,000	97,000 h
EM converterLED BASIC 202A	tc	65 °C	70 °C	75 °C
MH/LiFePO4 50V	life-time	> 100,000 h	>100,000	97,000 h
EM converterLED BASIC 203	tc	65 °C	70 °C	75 °C
MH/LiFePO4 50V	life-time	> 100,000 h	>100,000	89,000 h
EM converterLED BASIC 204	tc	65 °C	70 °C	75 °C
MH/LiFePO4 50V	life-time	> 100,000 h	>100,000	89,000 h





CEILING LIGHT

CEILING PANEL LIGHT



CE RoHS



D3
Model No.: PPG-HD003-CGXX

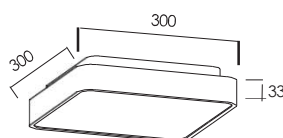

Trim Finish Optional:

- ☐ Matte White RAL 9016
- ☐ Matte Grey RAL 9006
- ☐ Matte Black RAL 9005



>80
>90



3000K



110°



Standard Mechanical Parameters

MAIN BODY MATERIAL: ALUMINIUM DIE-CASTING
SURFACE FINISH: MWRAL 9016
IP: 44
OVERALL DIMENSION: Φ 300X300MM

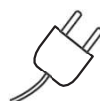

Standard Optical & Electrical Characteristics

LED BRAND: LUMILEDS
DRIVER BRAND: 3AAA
INPUT: 100-265V AC 50/60HZ
CCT: 4000K
Macadam3
CRI: > 80
PF>95
SYSTEM OUTPUT: 2400LM
SYSTEM POWER: 24W
BEAM: 110°

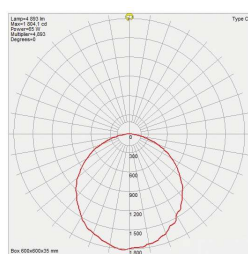

PPG-HD003-CGXX-20W-4000K-110°

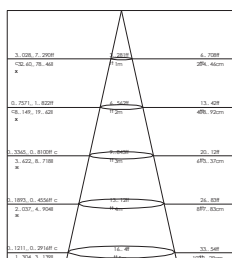

Photometric files for other CCT & beam are available



Standard Packing Information

CARTON BOX: 610X610X400MM
PCS CARTON: 30PCS
CARTON G.W.: 15KG

CEILING PANEL LIGHT 300 x 300



Model No.: PPG-HD003-CGXX

Provide an optimum visual comfort.

Among applications:

- Workspaces and Offices
- Lobbies, Stairwells
- Public areas: schools, administrative centers, sport centers,...
- Showrooms, Laboratories
- Replacement for fluorescent grid

+ Aesthetic lighting solution. Tempered safety glass for public areas.



ADVANTAGES

- ✓ Homogeneous colour temperature and stable in time.
- ✓ Its thinness allows easy mounting to the ceiling.
- ✓ Very simplified connection and very fast mounting. Smart design and tempered safety glass for public areas.
- ✓ Very good return on investment: no maintenance, estimated life of 50,000 hours, very low power consumptions.



MORE INFORMATION...

- Replacement solution to fluorescent tubes panels
- Single reference for 2 different mountings:
 - Recessed mode in a false ceiling
 - Suspended mode by slings
- Also available in dimmable version
- Optimum eyestrain tolerance level compared to fluorescent tube.



▼ Perfect homogeneity of the luminous flux

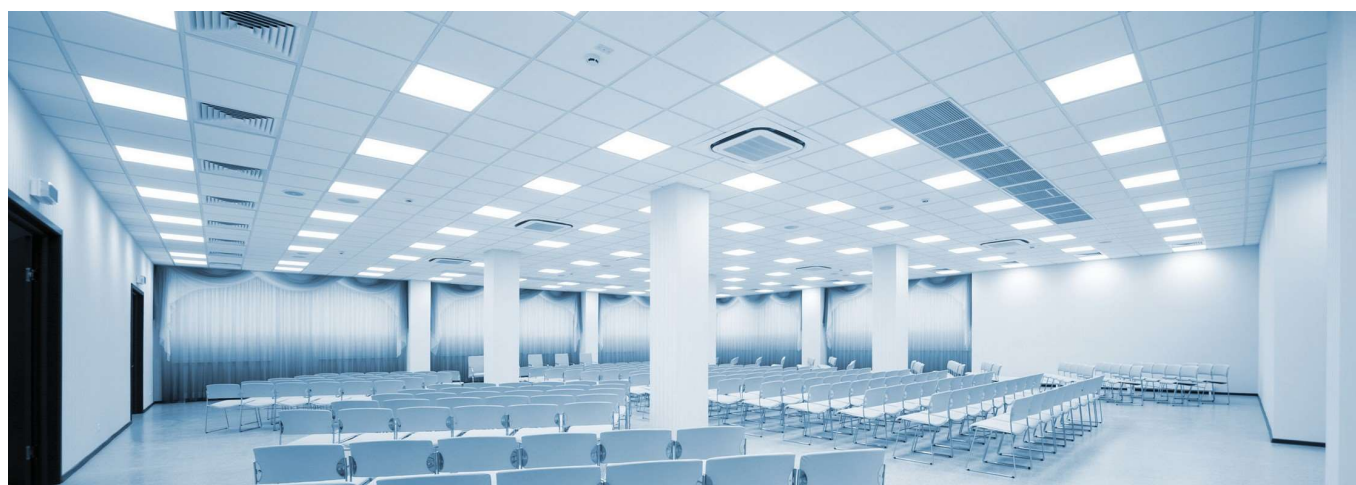

▼ Excellent luminous efficacy for public areas

MIRROR LIGHT



CE RoHS

Type: Mirror Light W1 General Information

Model No.: PPG-HW001-CGXX



Dimensions: 400X85X100mm

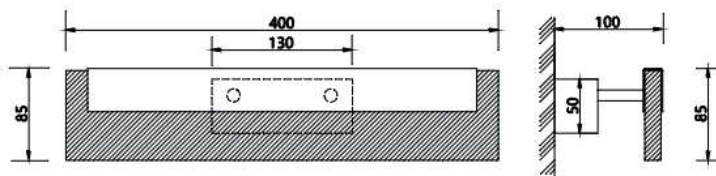

Materials&Color

Materials: Stainless steel, Acrylic

Color: Chrome

Technical Information:

LED Brand: LUMILEDS , Driver Brand: 3AAA ,
 Input: 100-265V AC 50/60Hz , CCT: 4000K ,
 System Power: 12W, CRI>80 ,
 System Output Flux: 1000lm , PF>95,
 Protection Degree: IP44 , Protection Class: Class II



Standard Packing Information

CARTON BOX: 540X340X300MM
 PCS/CARTON: 8 PCS
 CARTON G.W.: 12KG

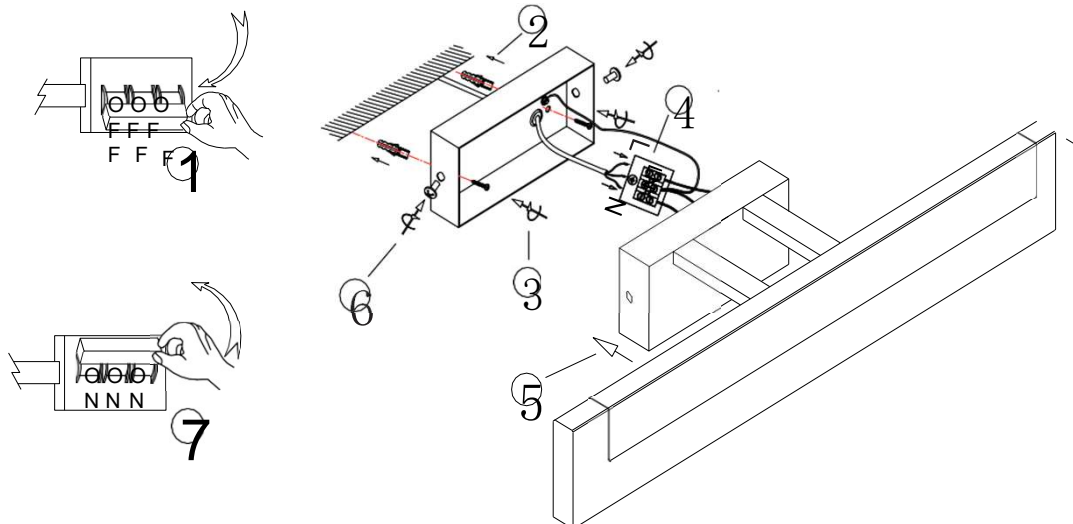

WALL LIGHT



W2

Model No.: PPG-HW002-CGXX

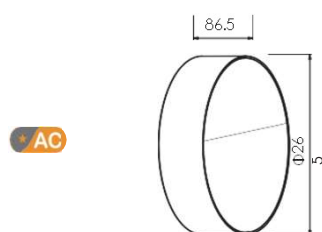

Working temperature: -30°C ~ 45°C, Die-casting aluminum lamp body, Opal PC diffuser; Silicone rubber gasket, Graphene powder coating finish, Anti-UV powder coating finish; suitable for all kinds of places, Modular design, Accurate light source, high performance in light color, low glare index!

Trim Finish Optional:

- ☐ Matte White RAL 9016
- ☐ Matte Grey RAL 9006
- ☐ Matte Black RAL 9005



Standard Mechanical Parameters

MAIN BODY MATERIAL: ALUMINIUM DIE-CASTING
SURFACE FINISH: MWRAL9016
IP: 65



Standard Optical & Electrical Characteristics

LED BRAND: LUMILEDS
DRIVER BRAND: 3AAA
INPUT: 100-265V AC50/60HZ
CCT: 4000K
CRI: > 80
PF>95
SYSTEM OUTPUT: 1380LM
SYSTEM POWER: 16W
BEAM: 100°

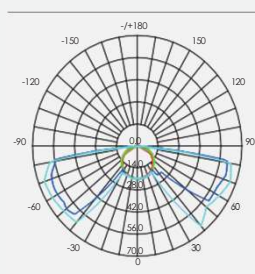

PPG-HW002-CGXX-16W-4000K-100°

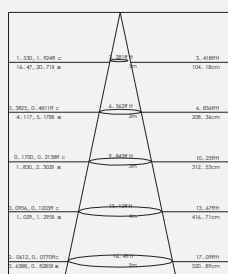

Photometric files for other CCT & beam are available



Standard Packing Information

CARTON BOX: 570X520X300MM
PCS/CARTON: 10PCS
CARTON G.W.: 24KG

EMERGENCY EXIT SIGN LIGHT

CE RoHS

PRODUCT FAMILY SERISE

This exit sign light has a modern design and suitable for any kind of project.

**FEATURES**Model No.: **PPG-HE001-CGXX**

- Test button and healthy charge indicator.
- 24 hours recharge time.
- Customerized panel and duration time is available.
- Overcharge and overdischarge protection.
- Low power consumption, long lifespan, good stability.
- Suspending mounted and recessed mounted is available.
- Apply to shopping Mall,Hotel,Office,Corridor and so on.



DIAMENSIONS 340*182*25mm	SPECIFICATION	
	Input Volated	AC100V-265V/50Hz
	LED type	6pcs/3V/0.06W/Φ5/LED/green light
	Batter	1.2V Ni-Cd
	Indicator	Green (Main Power); Red(Charging),Yellow (Error)
	Test button	Simulate emergency and shutdown emergency
	Charging time	Max 24hrs
	Duration time:	90mins/120mins/180mins
	Operation Mode:	Maintained
	Working Temperature:	0°C-40°C
	Material:	Aluminium housing with glass panel/ acrylic panel
	Installation	hanging mounted
	Packing	1pcs/inner box;10pcs/carton
	Customization	Battery,Duration time,Package

EMERGENCY EXIT SIGN LIGHT



CE RoHS



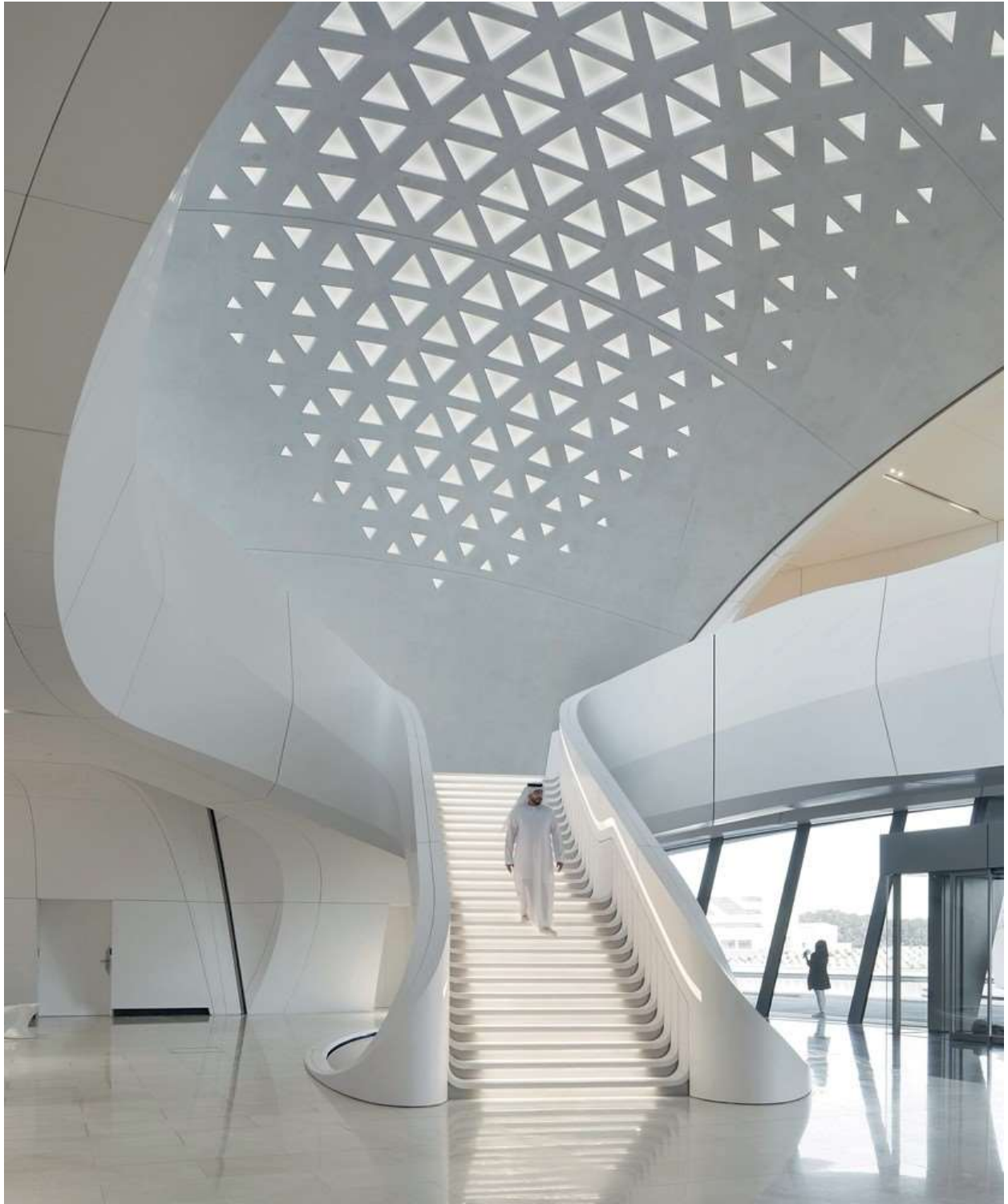



IP67 Plane Series - S Constant Voltage

Series Positive Bend e NS-102 & Side B

nd NS-202

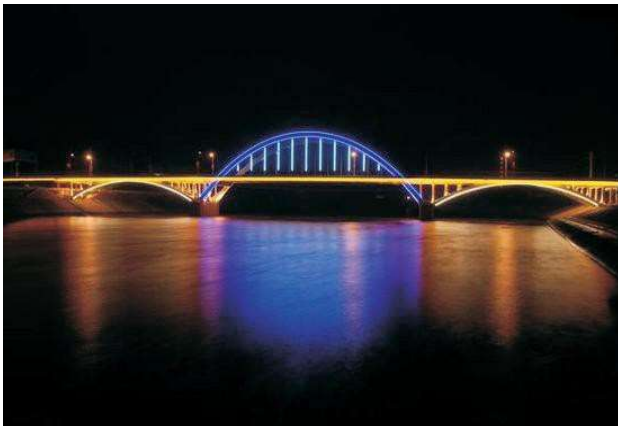
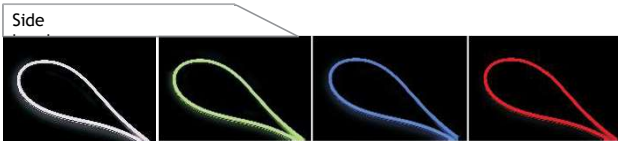
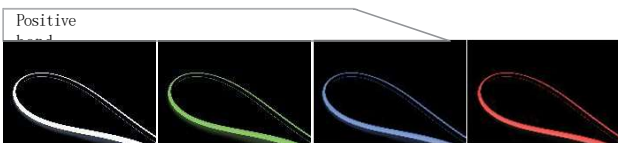

1. Flat structure design, square stereo appearance, and meet the needs of surface mount and embedded installation Application requirements.

2. Uniform illumination, no dark spots, soft and smooth light, creating a comfortable environment, single-ended power supply can support 20 meters [65.5ft] connection.

3. Adopting the technology of rubber plug glue to achieve IP67 waterproof grade, which can be used indoors or outdoors.

4. Cutting and welding assembly can be carried out at the construction site.

5. Support P W M dimming.

6. Using a healthy and environmentally friendly silicone material, it is produced through advanced extrusion process. Compared with the traditional neon tube glass shell material (easy to break) or PVC sheath material (easy to harden and yellow), the production capacity is higher. The appearance is more beautiful, the softness is better, the weather resistance is stronger, and the performance is more stable.

7. In the case of indoor use, 50,000 hours of life, 5 years warranty; 36,000 hours of life, 3 years warranty for outdoor use.

8. The product meets the requirements of UL and CE certification.

1. Backlighting of display cabinets, advertising boxes and display boards.

2. Decorative lighting for hotels, gardens and bridges.

3. Auxiliary lighting for corridors, ceilings, stairs, and passageways.

4. Illumination according to the type and structure model.

Protection level	schematic diagram	Feature description
IP20	LED 软板	不防水
IP54 Thin	LED 硅胶 软板	灌胶工艺 防溅水 尺寸变更少
IP54	LED 硅胶 软板	滴胶工艺 防溅水 尺寸变更少
IP65	LED 硅胶套 管 软板	套管工艺 防喷水 低色漂
IP67	LED 硅胶 套管 软板	灌胶工艺 可短时间浸水
IP68	LED 硅胶套管 软板	注胶工艺 可长时间浸水
IP54 Plus	LED 硅胶挤出套 管 软板	硅胶挤出工艺 防溅水 尺寸变更少 低色漂
IP67 Plus	LED 硅胶挤出套 管 软板	硅胶挤出工艺 可短时间浸水 低色漂
IP44/ IP65	LED PVC挤出套 管 软板	PVC挤出工艺 防喷水 低色漂

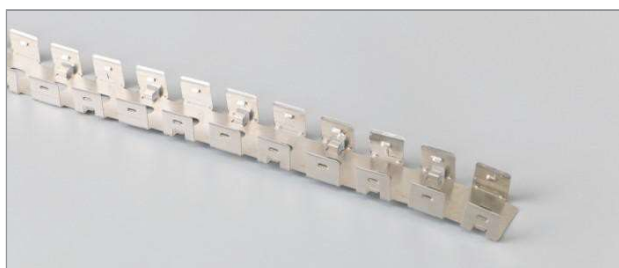

Positive bend
NS-102

Side bend
NS-202

Connection Diagram

Non-dimming situation

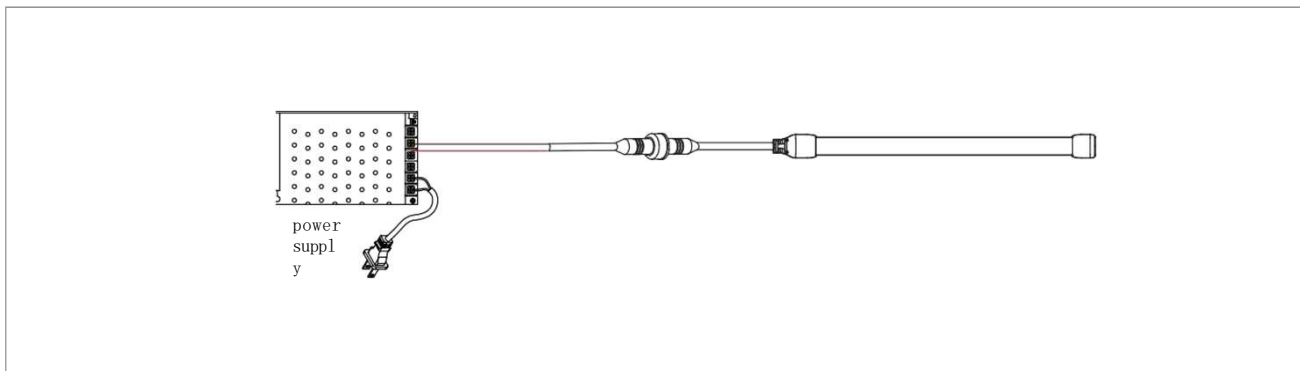

Dimming
situation

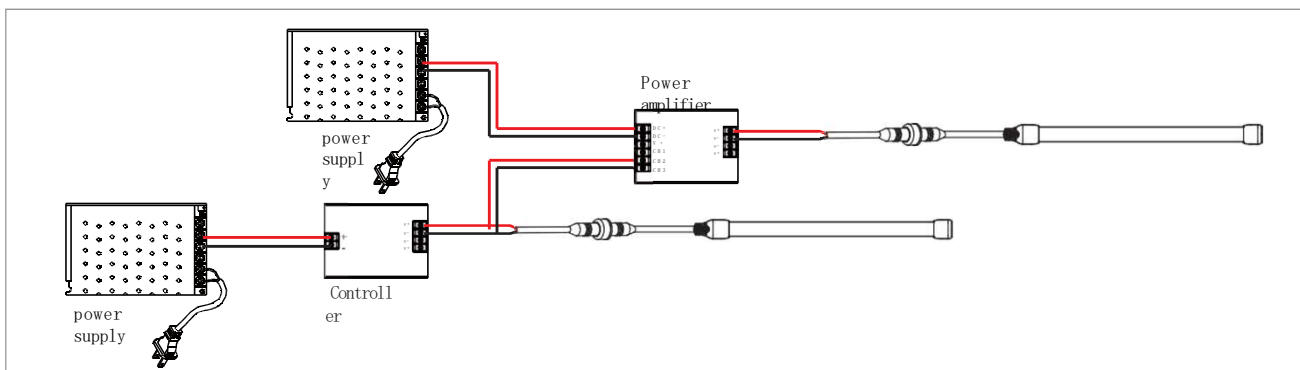

we love our lights, we enjoy our life



Antioch General Trading L.L.C.

Al Khabisi, Deira, Dubai Plot No 128-422,
Ahmed Redha Al Ansari Building, Office 203.

P.O.Box 114020 Dubai, United Arab Emirates

Mob & Whatsapp: +971 50 652 4074

Email: info@antiochdubai.ae

mohammed@antiochdubai.ae

